

Sample

# Title Plan

## (Registry Map)

Contents:

- Title Plan
- Title Plan Information Guide (page 2 shown)



**Land & Property Services.**  
THE LAND REGISTRY

Date: 14 Jun 2012  
 County: Down  
 Folio: DN108010L  
 Scale: 1:1250  
 Our Ref: 2012/260230  
 Your Ref: aust484  
 Map Ref(s): 14810NE3,14810NE4,14810SE1,  
 14810SE2  
 Sheet 1 of 1

Key to folio labels:

*a* - DN108010L

This map is for location purposes only (Rule 141(1) of the Land Registration Rule (Northern Ireland) 1994 as amended by paragraph 19 of the Schedule to the Amendment Rules 2000). Folio boundaries are not guaranteed, (Section 64 of the Land Registration Act (Northern Ireland) 1970). The co-incidence of Land Registry markings and OSNI features may have been affected by revisions of the OSNI map subsequent to registration.

This map has been prepared using the largest scale Land Registry map available for the area. Any future Dotted map should be based on the largest scale OS Irish Grid Plan available for the area.  
 N.B. Folio boundaries are not conclusive (unless so described on the folio). See 564 of the Land Registration Act (NI) 1970. Where there is any doubt concerning boundaries, the original Instrument or Document should be inspected.

This copy map shows the location of the lands comprised in the folio listed above.

**Crown Copyright Reserved**

This map may only be produced with the permission of the Land Registry and Ordnance Survey of Northern Ireland. Based upon Ordnance Survey of Northern Ireland's data with the permission of the Controller of Her Majesty's Stationery Office, Crown copyright and database rights EM02071.

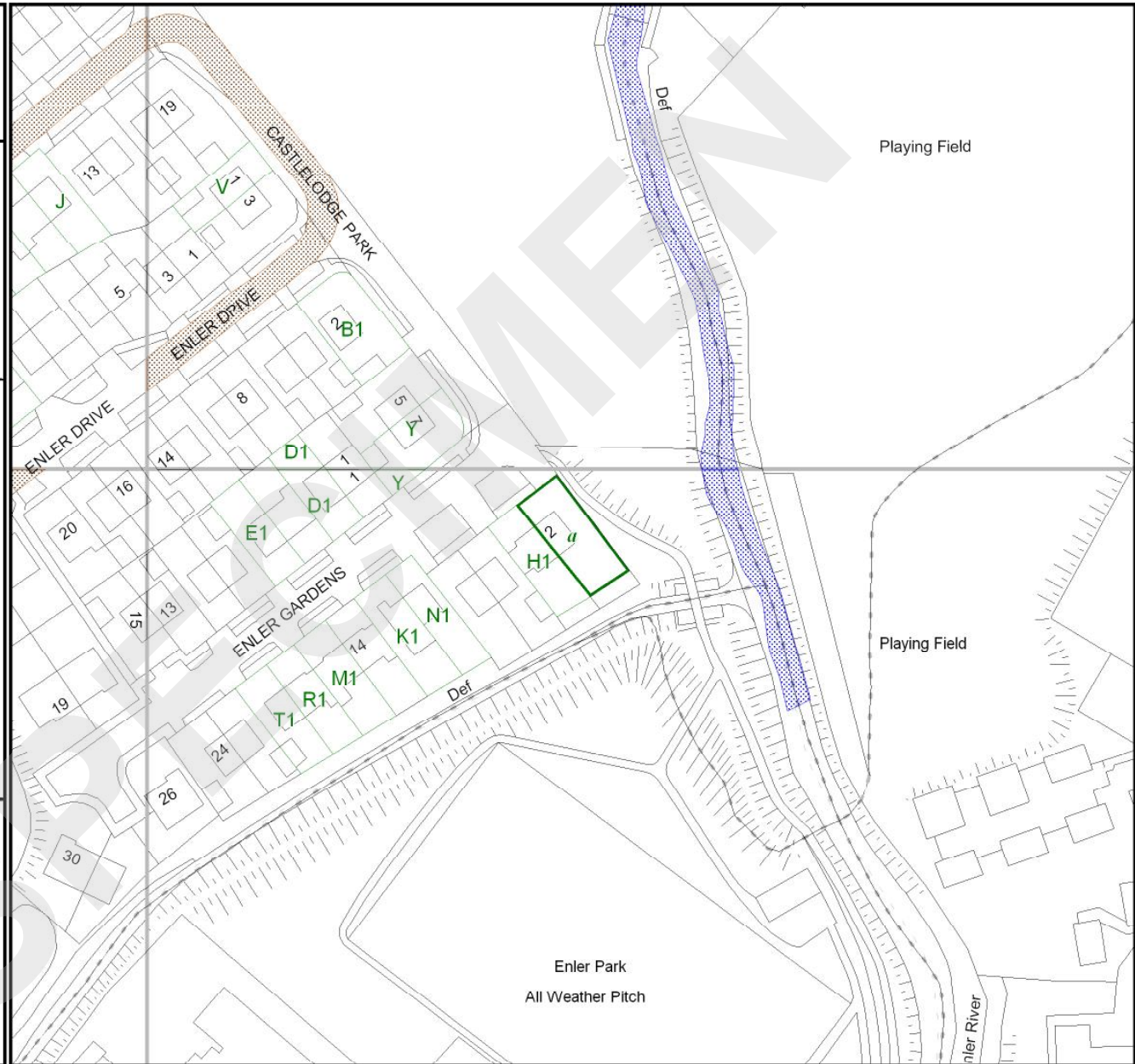

## Title Plan (Registry Map)

### Contents

- Relevant Law
- Property Boundaries
- General Boundaries
- Scale and North Point
- Coloured Edging
- Coloured Tints
- OSNI Positional Accuracy
- T & H Marks
- Other Data on the Title Plan
- Detail Shown



### RELEVANT LAW

Land Registration in Northern Ireland is determined by the Land Registration Act (Northern Ireland) 1970, Registration of Deeds Act 1970, Registration (Land and Deeds) (Northern Ireland) Order 1992 and the Registration of Deeds Regulations (Northern Ireland) 1997.

Section 10 of the 1970 Act provides that a Register shall be kept in respect of freehold and leasehold estates in land, and certain legal interests in the land such as incorporeal rights held in gross (e.g. fishing rights).

Section 62 provides that a Registry Map, based on the Ordnance Survey for Northern Ireland (OSNI) should also be kept. This is the Title Plan.

These 2 documents together comprise the documents of Title, and refer to each other.